



BHARAT SANCHAR NIGAM LIMITED

(A Govt. of India Enterprise)

Office of the Chief General Manager, Telecom Projects, E/Zone,
Microwave Survey Division,
2/5A, Judges Court Road, Alipore, Kolkata – 700 027

No-G/MWC/1-150/T.B/2016-17/Vol-V/24

Dated at Kolkata 06-07-2017

To
M/s Forum Projects Pvt. Ltd.
4/1, Red Cross Place,
Kolkata-700001

REVISED

Sub:-Clearance of height of the proposed buildings at Premise No. 1001/A, Eastern Metropolitan Bye Pass, Ward no. 66, Borough-VII of KMC, Kolkata-700046.

Ref: G/MWC/1-150/T.B/2010-11/08/Vol-IV dated 24/07/2010

In connection with your application regarding above mentioned subject, it is observed that there is no physical obstruction to the Working BSNL Microwave schemes for the proposed buildings as per drawing supplied with your application (maximum height of 144.49 meter above Ground level), hence the height of the proposed buildings at the above mentioned premises has been cleared up to **144.49M (One Hundred Forty Four Point Four Nine meters only)** above ground level including lift machine room and water tank on the roof top. **It is further stated that the earlier clearance from this office vide no. G/MWC/1-150/T.B/2010-11/08/Vol-IV dated 24/07/2010 may be treated as cancelled.**

One set of drawings, duly signed is returned herewith. **Any change/alteration/Modification in the drawings with respect to upward revision of height and/or shifting of Building Footprint is not permissible and strictly prohibited**

Encl: - As stated

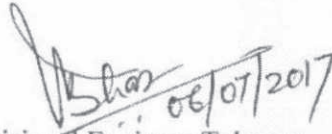
Divisional Engineer Telecom.
Microwave Survey Division
Kolkata.



EXECUTIVE ARCHITECT



Practice Design Pvt. Ltd. | Technopolis | Sector 5 |
 Saltlake City | Kolkata 700091
 +91 33 4005 3131

PURPOSE OF RELEASE

RESUBMISSION TO K.M.C.

STAGE

MUNICIPAL

DIRECTION



Drawing No.

001

Current Revision

R3

Start Date

15-Oct-12

Issue Date

27 JULY 16

Last saved Date

27 JULY 16

Project Code

fp - 28

Bldg/Block

WING-A AND WING-B

Floor

FLOOR PLAN

Drawing title

SITE PLAN . LOCATION PLAN
 GROUND FLOOR PLAN

Author: [Name], Date: [Date], Project: [Project Name], Drawing No: [Drawing No]

2	W2	2000	2400	2400	2400	MANAGEMENT OFFICE
3	W3	300	2400	2400	2400	MANAGEMENT OFFICE

*Height of the proposed building cleared for
 144.49 M (one Hundred Forty Four Point
 Four Nine Meters only) above ground level
 including lift Machine room and water
 tank on the roof top.*

[Signature]

Divisional Engineer
 Microwave Survey Division
 Telecom Projects, Eastern Zone
 B. S. N. L.
 2/5A, Judges Court Road, Kol-27

2903.69	2000	2400	2400	2400	MANAGEMENT OFFICE
920.96	300	2400	2400	2400	MANAGEMENT OFFICE
1182					
50					
3168.61 SOM					
1475.00					
3888.91 SOM					
3.221					
8086.56	Required Parking	80			
7811.28		72			
504.74		5			
7800		64			
8108.4		72			
560.92		5			
303		303			
46		46			
352		352			
1475.00					
180.72					
829.4					
850.4					
1628.08					
6798.72					



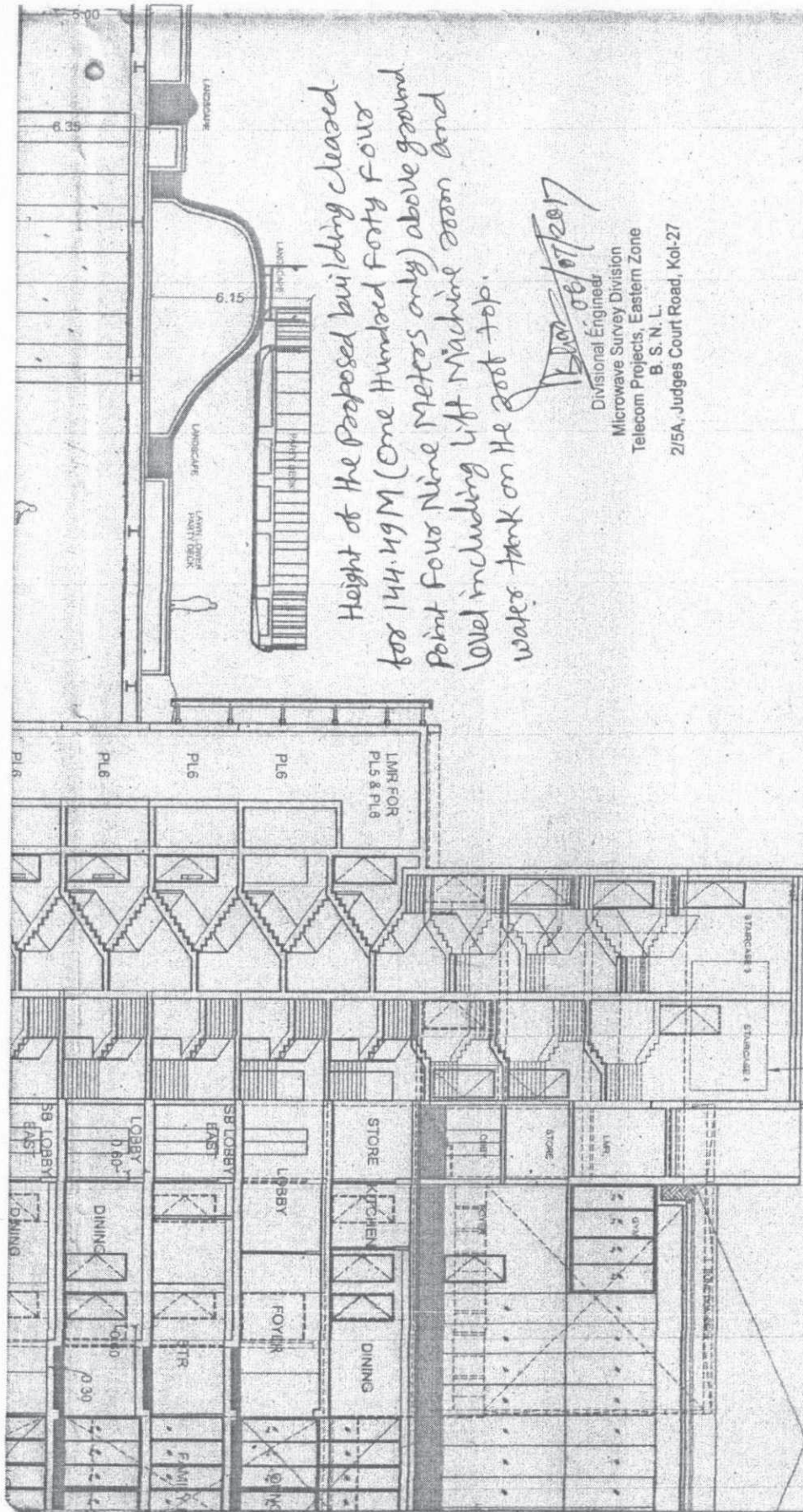

Height of the Proposed building cleared for 144.19M (One Hundred forty Four Point Four Nine Meters only) above ground level including lift Machine room and water tank on the roof top.

B. S. N. L.

Divisional Engineer
 Microwave Survey Division
 Telecom Projects, Eastern Zone
 B. S. N. L.
 2/5A, Judges Court Road, Kol-27

